

## DC Current Source Selector Guide

Max Current (A)	Max Compliance Voltage					Source Channels	Max Power (W)	
	50V	100V	200V	300V	400V		Per Channel	Total
0.5	✓	✓	✓	✓	✓	1, 2, 4, 8	200	1600
1	✓	✓	✓	✓	✓	1, 2, 4, 8	400	3200
2	✓	✓	✓	✓	✓	1, 2, 4, 8	800	6400
3	✓	✓	✓	✓	✓	1, 2, 4, 8	1000	8000
4	✓	✓	✓	✓	✓	1, 2, 4, 8	1000	8000
5	✓	✓	✓			1, 2, 4, 8	1000	8000
7.5	✓					1, 2, 4, 8	375	3000
10	✓	✓	✓			1, 2, 4	1600	6400
12.5	✓	✓				1, 2, 4	1250	5000
15	✓					1, 2, 4	750	3000
20	✓	✓	✓			1, 2	3200	6400
25	✓	✓				1, 2	2500	5000
30	✓					1, 2	1500	3000
40	✓	✓	✓			1	6400	6400
50	✓	✓				1	5000	5000
60	✓					1	3000	3000
0.1				✓		32	30	960
0.2	✓					32	10	320

Use this table/selector guide to select your current source and determine your model number. Instructions available on the next page.

# How to Use this Current Source Selector Guide

On the previous page, find the columns labeled “Max Current”, “Max Compliance Voltage”, and “Source Channels” to select your current source. To determine your model number, use the model number guide below.

SS400-DC-BBB-CC-DDE

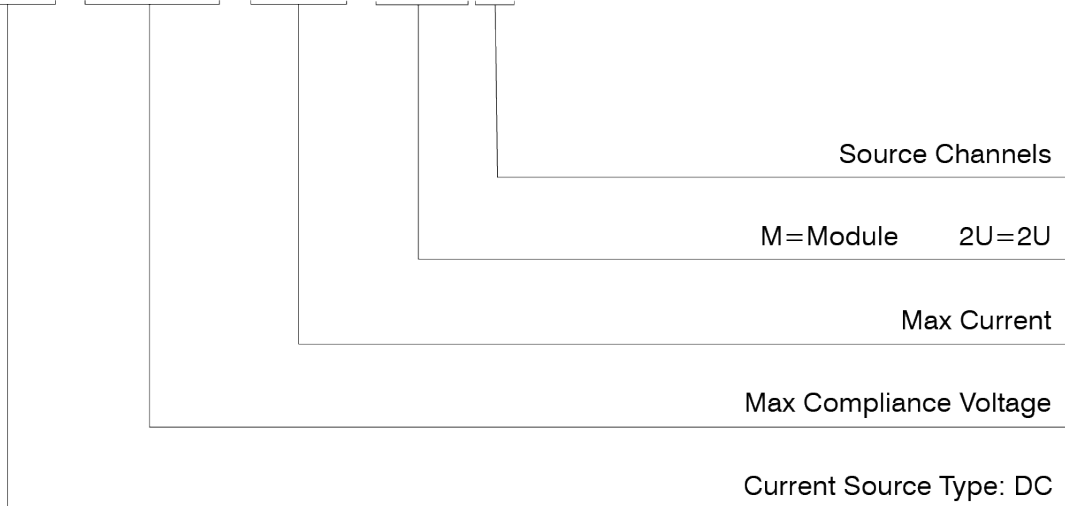

## Vektrex System Configuration Options

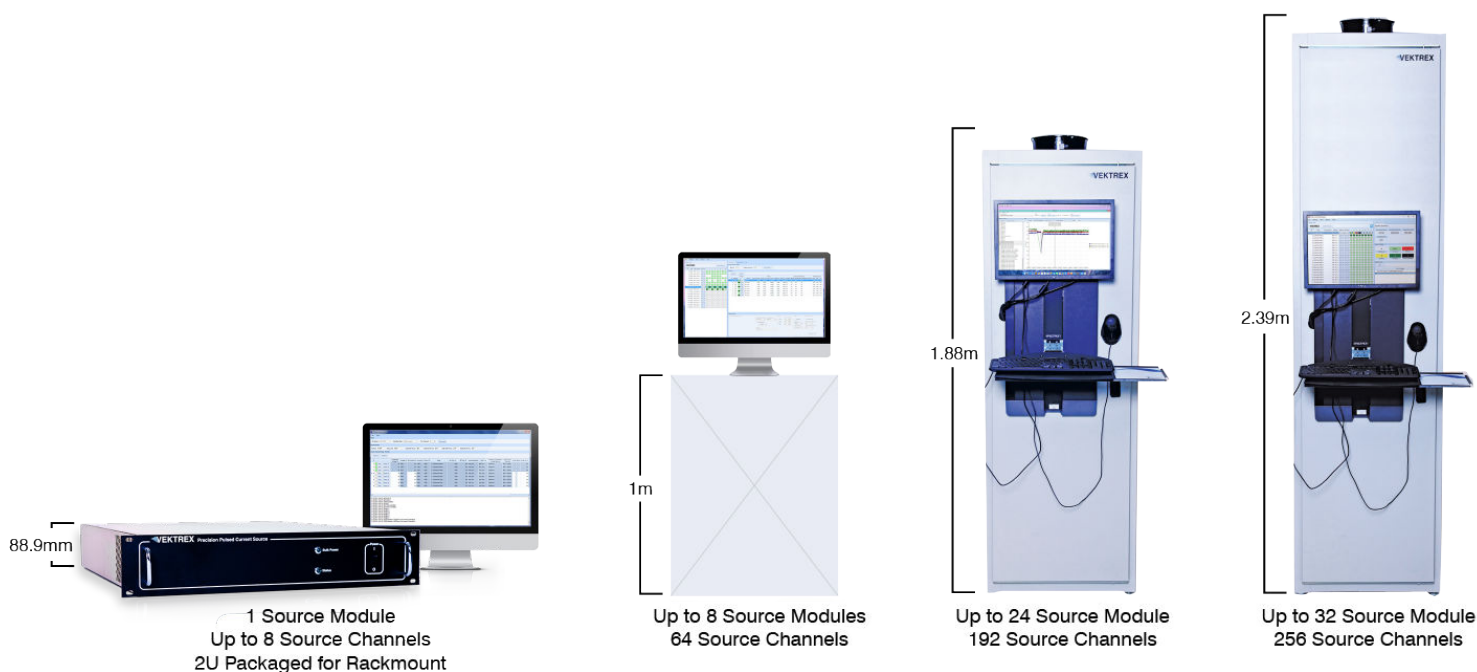

If you would like assistance selecting the optimal current source for your application, please contact [sales@vektrex.com](mailto:sales@vektrex.com).